

Installation

S17318 - 15W LED CCT Emergency, & Microwave & Corridor Gear Tray

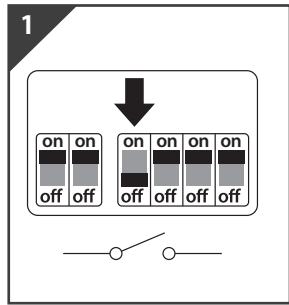

1 Switch OFF at mains supply before installing

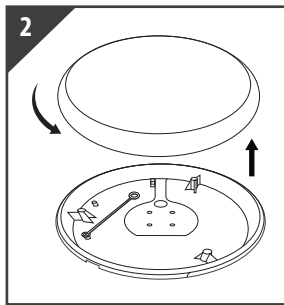

2 Hold the base securely and twist to unlock and remove the diffuser

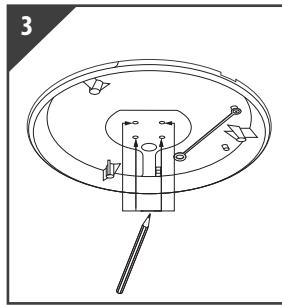

3 Ensure product is located in the correct location and mark the fixing surface

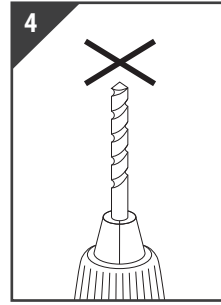

4 Use correct drill bit to drill screw holes

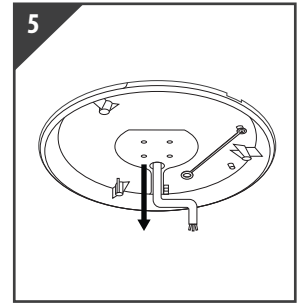

5 Pull power supply through hole in the base plate

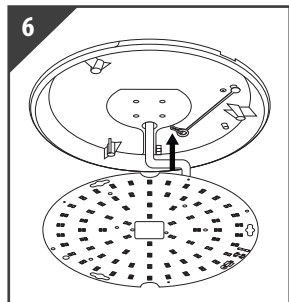

6 Attach safety belt to gear tray

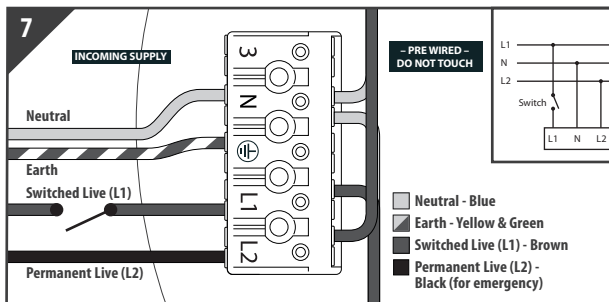

7 Press the individual terminal and insert the correct incoming supply before releasing the terminal to secure. The product **MUST** be earthed
Note: Please ensure there are no switches, PIRS etc in the permanent live feed, as switching of the emergency pack will reduce the battery's life considerably

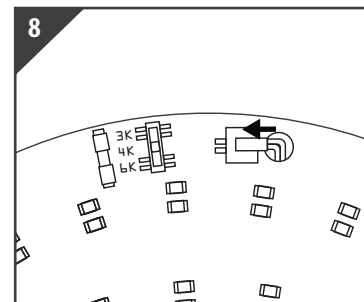

8 Connect battery pack cable to lamp panel

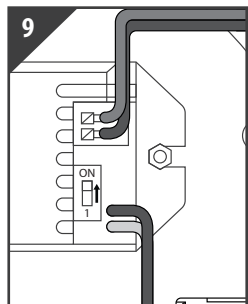

9 Change battery switch to 'ON' position

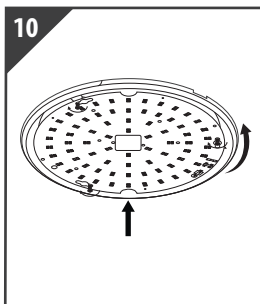

10 Align gear tray with screws and tighten

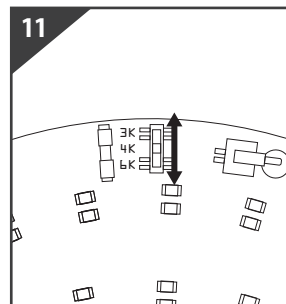

11 Use the CCT selection switch on the gear tray to select the desired colour temperature

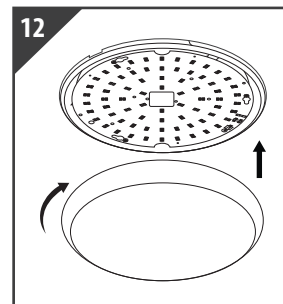

12 Push and twist the diffuser back into place

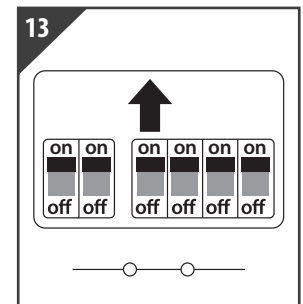

13 Return power. Switch ON at mains supply

Packaging Information

	SIZE(CM)	N.W/pc (KGS)	G.W.(KGS)	Q'TY(PCS)
Carton	52*43*27	0.25	7.2	20

	CTNS	Q'TY(PCS)	VOLUME(CBM)
20" standard container	400	8000	28
40" standard container	865	17300	58

